

టెంపుల్ సిటీ... స్టార్ సిటీగా రూపుదిద్దుకుంటున్న మన తిరుపతి

ఇంటర్నేషనల్ ఎయిర్పోర్టు, ఇండస్ట్రియల్ జోన్స్, హాస్పిటల్స్, టూరిజం కాలిజార్, ఎడ్యుకేషనల్ హబ్స్

కేంద్రప్రభుత్వం వారి 1500 కోట్ల నిధులతో

తిరుపతి మహానగరంగా మారుతున్న తరుణంలో

పవిత్ర పుణ్యక్షేత్రం... తిరుపతి

తిరుపతి నగరం ప్రపంచ వ్యాప్తంగా యాత్రికులను ఆకర్షిస్తున్న ప్రధాన పుణ్యక్షేత్రం, తిరుమల కలియుగ ప్రత్యక్షదైవం శ్రీ వేంకటేశ్వర స్వామి కొలువైవున్న శేషలికొండల ప్రకృతి సౌందర్యానికి ఆటపట్టు ఈ నగరం శ్రీ వేంకటేశ్వర విశ్వవిద్యాలయం, పద్మావతి మహిళా విశ్వవిద్యాలయం, IIT, IISER, NIMZ జాతీయ సంస్కృత విశ్వవిద్యాలయం, వేద విశ్వవిద్యాలయం వంటి ఆధునిక, ధార్మిక విద్యాసంస్థలలో పాటు తిరుపతి నేడు BHEL, Celkon, Karbon, Amararaja వంటి మరెన్నో పరిశ్రమలతో తిరుపతి పారిశ్రామిక నగరంగాను అభివృద్ధి చెందుతోంది. ఆధునిక ఆసుపత్రులు, విలాసవంతమైన హోటల్స్, షాపింగ్ మాల్స్ ప్రపంచ స్థాయి ప్రమాణాలను అందించే పాఠశాలలు తిరుపతి నగరం రూపురేఖల్ని మార్చి వేసాయి. దేశంలోని అన్ని ప్రధాన నగరాలతో రోడ్డు, రైలు మరియు విమాన రవాణా సౌకర్యాలు కలిగిన నగరం తిరుపతి.

ఒక్క క్షణం ఆలోచించండి ...మీ ఆర్థిక స్వాతంత్ర్యానికి ఇదే సరైన సమయం

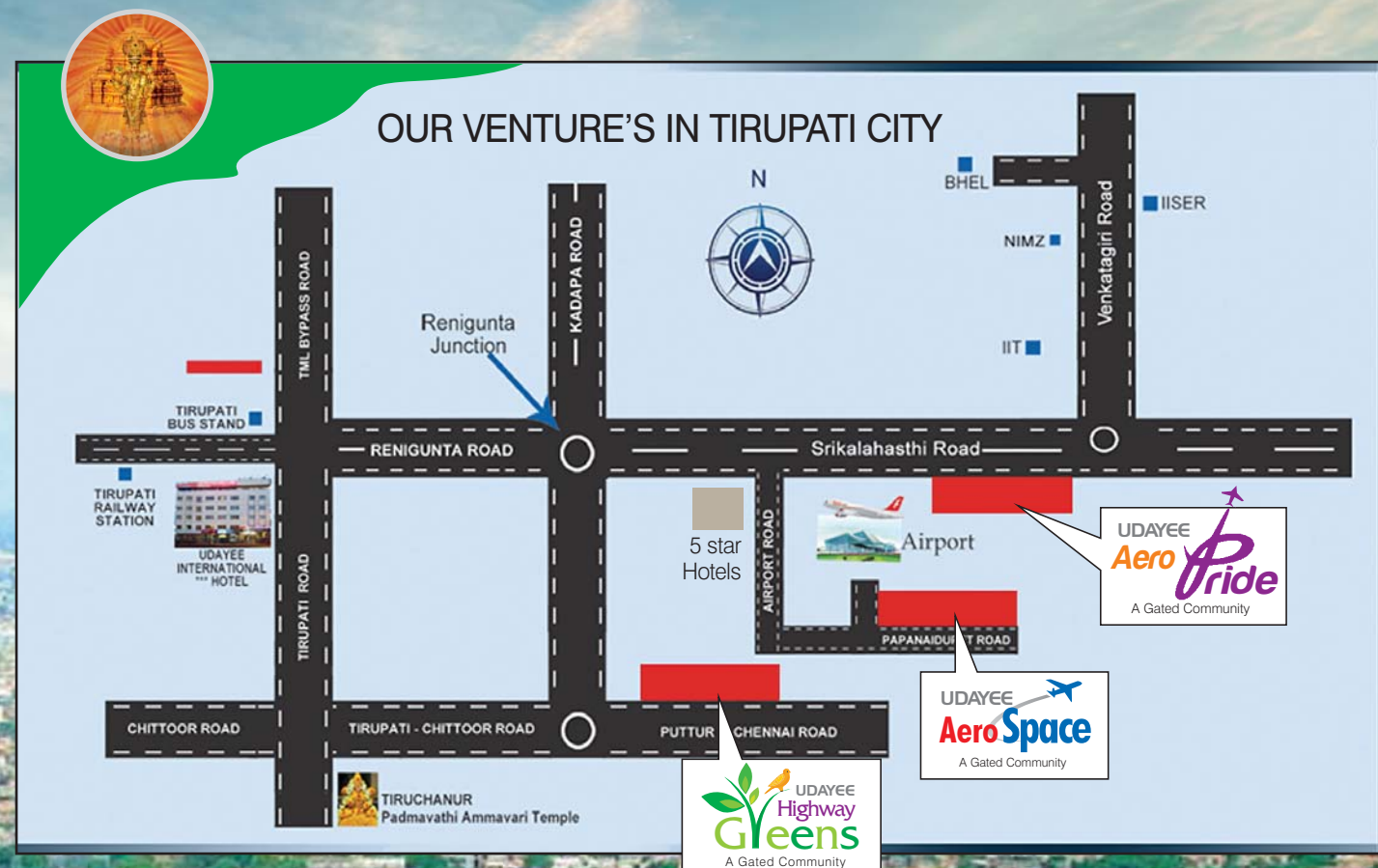

Right Developer...
Right Projects...
Right Investment

Where
Serenity
Meets



UDAYEE BUILDERS & REALTORS
A Unit of Udayee International Hotel India Pvt. Ltd.,
An ISO 9001:2008 Certified Company



UDAYEE Builders and Realtors India Private Limited

A Unit of Udayee International Hotel India Pvt. Ltd.,

5th Floor, Udayee International Hotel, Opp. APSRTC Bus Station, Tirupati.

Tel : 0877-2266583, 2266584, 77 99 88 5274.

www.udayeebuildersandrealtors.com Email: marketing@udayeebuildersandrealtors.com

An ISO 9001:2008 Certified Company



Creating landmarks...
Setting benchmarks

Live where... Life comes alive.



www.udayee.com



The company believes that each project is to be delivered on time and each of the initiatives is directed to build trust.

Welcome to Udayee BUILDERS & REALTORS

We choose RIGHT place
...for RIGHT leisure



A promise...



A promise delivered to each and every client by Mr. Giribabu, the Chairman and Managing Director of Udayee Group.

The Group is doing the business of Realtors & Builders Nestled at prime locations in Tirupati all projects designed on eco-friendly construction practices. Land as well as its location is the core of every reality project. Udayee is one of the leading land sellers in and around Tirupati. The onny realesates company having large land bank & An ISO 9001:2008 Certified company Rayalaseema.



Creating landmarks... Setting benchmarks



HOSPITALITY



REALTORS



BUILDERS



SUPER SPECIALITY HOSPITAL

ABOUT US

UDAYEE BUILDERS AND REALTORS INDIA PVT LTD., Tirupati founded by Mr. Bathala Giribabu, B.E., Mrs. Bathala Vasantha and his 3 (three) son's started Sri Sai Venkateswara Lodge & Medicals with 22 keys and provided impressed services to the customer's. Our customer's enjoyed the hospitality and keep on encourages us to grow more. We started our new 3 star Udayee International Hotel which consist of 120 keys and successfully running from fast 4 years. Starting up very soon Udayees B.V.N. Residency with 36 keys (which is under construction).

We are also involved into an integrated, full Real Estate service that has transformed with several of Tirupati's project developments such as Udayee Homes (Kayampet) Project, Udayee Highway Greens (Padiredu) Project, Udayee Aerospace (Airport) Project, and Udayee Aeroprige, Opp to Sree Engineering College Project. Now we have successfully completed Udayee Homes (Kayampet) Project which was started in November 2014. As if now we are running with 3 different projects.

We are one of the most respected company in the Real Estate Industry in South India, the growth of Udayee Builders and Realtors India Pvt. Ltd. has practically mirrored as Tirupati is one of the fastest growing city in India.



WE SELLING PREMIUM PLOTS



WE BUILT

RESIDENTIAL | HOUSES | COMMERCIALS

Our other division



Udayee International Hotel
Udayee's B.V.N Residency



welcome to UDAYEE
the greener side of life.
give life its refreshing moments



step into place of blessing

Tirupati City is located in the southeastern part of Andhra Pradesh, in Chittoor district. It lies about 145-km northwest of Chennai in the Palkonda Hills. Tirupati is known as the abode of the Hindu god Balaji (also praised as 'Venkateswara'), 'Lord of Seven Hills'. About 10-km northwest of Tirupati, at an elevation of 750m, is the sacred hill of Tirumala, which was considered very holy. One of the most important pilgrimage centers in India, the temple draws millions of pilgrims and is believed to be the busiest pilgrimage centre in the world.

A priceless property

Welcome to Udayee Realttors - a picturesque hillside town in Tirupati, Andhra Pradesh. Tirupati in history was richly endowed by the kings and emperors of various dynasties thus owing to its current reputation as the richest and most opulent temple in the world. The town is a heaven for people from different walks of life. There's something in the culture, character, remnants of colonial architecture that make you settle in and not to leave the place.

With age-old landmarks and breathtaking hills and greenery, you can now set peace of mind as your highest goal, and organize your life around it. As Tirupati is one of the upcoming smartcity in Andhra Pradesh with International Airport, IIT, IISER, IT Hubs, Padmavathi Medical College, 5 Star Hotels, International Cricket Stadium, Industrial Zone, Hospital, Tourism Corridor, Educational Hub and 1500 core's JNNURM Scheme sanctioned by Government of India to make Tirupati as mega city.



The blessed Townships of Tirupati



@ Mallavaram NH-18,
Opp. Sree Engineering College
Near to 5 Star Hotel



@ Opp. International
Airport &
Cricket Stadium
(Upcoming)



@ Near Padiredu
Vadamala pet
Highway Junction



ఆరోగ్యం

ఆదాయం

ఆనందం

DISTANCES

- 15 kms from APSRTC Bus Station
- 2.5 Km from International Airport
- 16 km from Railway Station

VENTURE FEATURES

- > Layout on NH 18
- > Coming up IIT, IISER
- > 40 ft. wide BT roads
- > Abundant Ground Water
- > Drains with chambers
- > Away from sound and pollution
- > Compound wall with arch entrance
- > Good water facility
- > Power facility
- > Avenue plantation
- > Safety gate with strong security
- > Layout design as per VAASTHU

Padmavathi Medical College 2 kms
IIT, IISER Institutions coming up
CELKON, KARBON Mobile companies are coming up



Right Developer...Right Projects... Right Investment

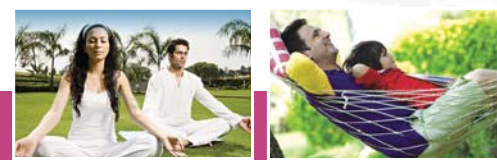

The perfect blend of

Luxury & Serenity



All Approval
Residential Land
Ready Possiession

Survey Nos.: 219/1A@, 1B
Chinna Anjimedu, Yerpedu Mandal
Tirupati, Chittoor Dist., A.P.



UDAYEE AeroPride

A Gated Community

@ Mallavaram, NH-18,
Opp. Sree Engineering College



Udayee Group presenting "AERO PRIDE", offer limited plots where in only a few premium people can afford to be a part of Tirupati.

A sprawling landscape of where you can live comfortably and healthy with your loved ones, in supported community, amidst all the necessary conveniences. This led to city expansion with smililar symphony.

AERO PRIDE, the place with greenery and pollution free environment, rich heritage, completed with strident commerical progress. The township beholds beautiful gardens and parks with many more green belts still to be planted.

ఆరోగ్యం

ఆదాయం

ఆనందం

DISTANCES

- 11 kms from APSRTC Bus Station
- 2 Km from International Airport
- 10 km from Padmavathi Temple

VENTURE FEATURES

- > Just opposite to Deccan University
- > Comping up International Cricket Stadium
- > Opposite to Asia's No.1 International culinary university
- > 40 ft. wide BT roads
- > Abundant Ground Water
- > Compound wall with arch entrance
- > Avenue plantation
- > Drains with chambers
- > Safety gate with strong security
- > Away from sound and pollution
- > Layout designed as per VAASTHU



Right Developer...Right Projects... Right Investment



The perfect blend of

Luxury & Serenity



All Approval Residential Land Ready Possession

UDAYEE AeroSpace

A Gated Community

@ Opp. International Airport & Cricket Stadium (Upcoming), Tirupati



Udayee Group presenting "AERO SPACE", offer limited plots where in only a few premium people can afford to be a part of Tirupati.

A sprawling landscape of where you can live comfortably and healthy with your loved ones, in supported community, amidst all the necessary conveniences. This led to city expansion with smililar symphony.

AERO SPACE, the place with greenery and pollution free environment, rich heritage, completed with strident commerical progress. The township beholds close visionary of main terminal, runways , landing and take off.

Servey Nos.: 6-1, 1A TP 1M, 7/1, 8, 9 Kurakalva Village Ranigunta Mandal Tirupati, Chittoor Dist., A.P.

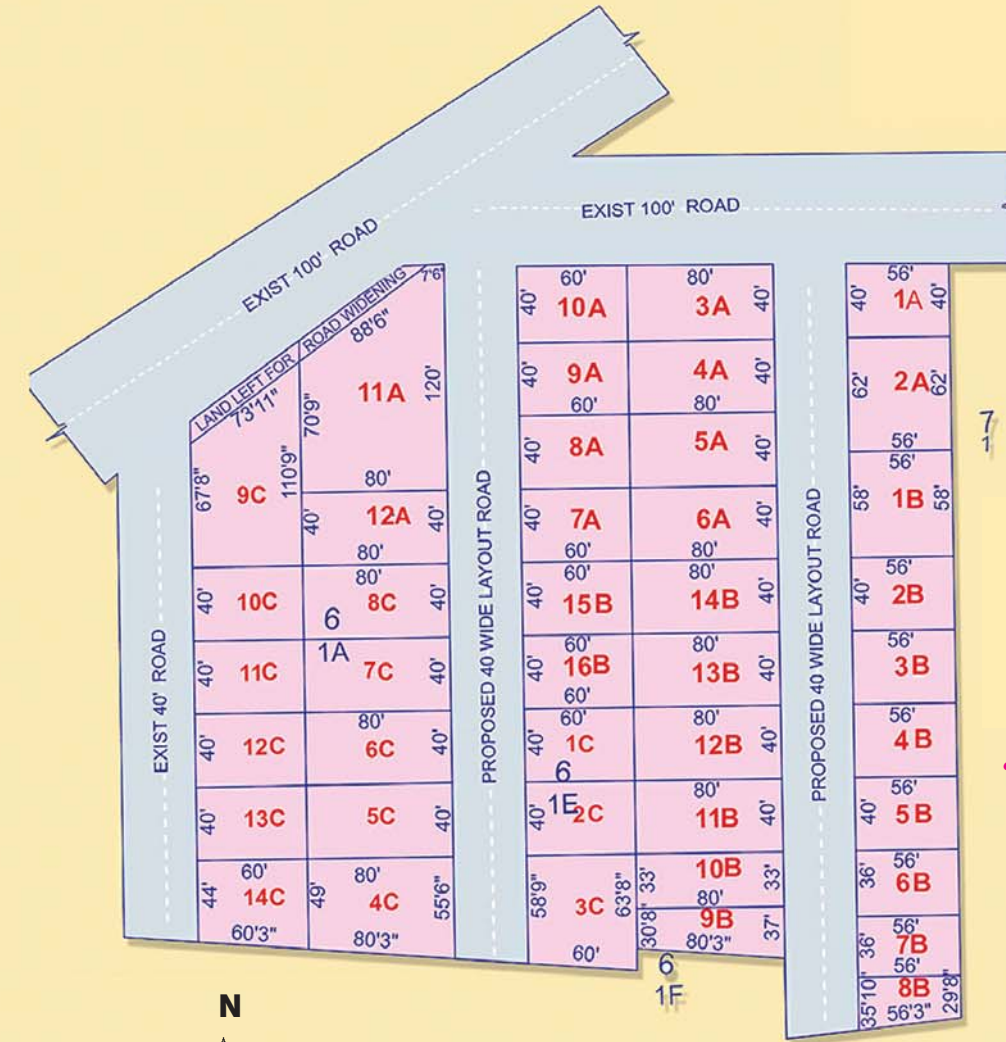

"మీరు వెచ్చించే ధర... అతి వేగంగా రెట్టింపు" అనే నినాదంతో... అభివృద్ధికి అవకాశం కలిగిన స్థలాలు, నివాసములకు అనుకూని విద్యాలయాలు, ఆసుపత్రులు, వాణిజ్య సముదాయాలకు అతిచేరువలో నిరంతర రవాణా సౌకర్యాలతో అత్యున్నత ప్రమాణాలతో 100% వాస్తు కలిగి, అందరికీ అందుబాటు ధరలలో... అంతర్జాతీయ ప్రమాణాలతో, ఆధునిక జీవన విధానానికి అనుగుణంగా అణువణువు ఆధునికత ఉట్టిపడే విలాసవంతమైన నివాసాలకు మరియు విలాసవంతమైన సదుపాయాలు మా ప్రత్యేకత.





ఆరోగ్యం

ఆదాయం

ఆనందం

DISTANCES

- 16 kms from APSRTC Bus Station
- 8 Km from International Airport
- 16 km from Railway Station

VENTURE FEATURES

- > The project on National Highway 205
- > 40 ft. wide BT roads
- > Abundant Ground Water
- > Avenue plantation
- > Drains with chambers
- > Surrounded with greenery
- > Power facility
- > Away from sound and pollution
- > Compound wall with arch entrance
- > Safety gate with strong security
- > Layout designed as per VAAS



Right Developer...Right Projects... Right Investment



The perfect blend of

Luxury & Serenity



All Approval Residential Land Ready Possiession

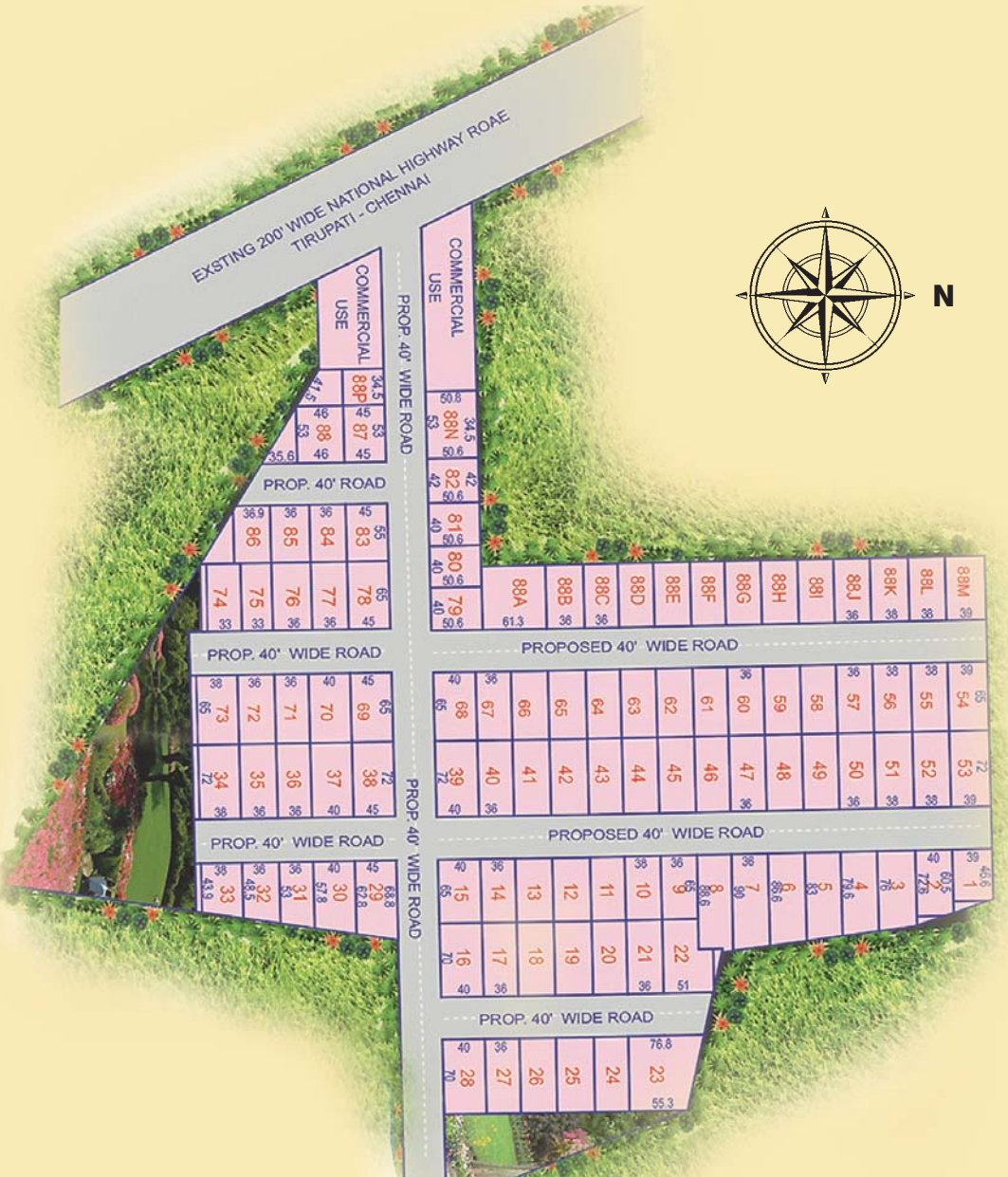

296, 305, 306
Pediredu Village, Vadamala
Tirupati, Chittoor Dist., A.P.

టెంపుల్ సిటీ...
స్మార్ట్ సిటీగా
రూపుబద్ధుకుంటున్న
మన తిరుపతి



International Airport



A Gated Community

@ Padiredu Village
Tirupati



Udayee Group presenting "HIGHWAY GREENS", offer limited plots where in only a few premium people can afford to be a part of Tirupati.

A sprawling landscape of where you can live comfortably and healthy with your loved ones, in supported community, amidst all the necessary conveniences. This led to city expansion with smiliar symphony.

HIGHWAY GREENS, the place with green and pollution free environment, rich heritage, completed with strident commerical progress. The township beholds beautifl gardens and parks with many more green belts still to be planted.